

# SPECIFICATION SHEET MODEL 611 (3" - 10")



## Valve Setter Mechanical Joint by Mechanical Joint

### Valve Setter Mechanical Joint by Mechanical Joint

U.S. Patent No. 5,392,803

The model 611 mechanical joint by mechanical joint valve setter is constructed of fusion epoxy coated ductile iron. Valve setters are designed to augment the installation of the "N" series backflow prevention valves. Integral ductile iron support between elbows transfers thrust downstream, thus eliminating thrust block requirements between elbows. Mechanical joint restraint devices may be used at pipe connections, depending on local conditions.

### Ratings

Maximum Working Pressure    175 psi (1200 KPa)  
 Temperature Range            32° to 140° (0°C to 60°)

### Features

- Corrosion resistant fusion epoxy coated.
- Eliminates the need for thrust blocks or other restraints at the point of installation.
- Flanges:  
ANSI AWWA C153 A21.53-88.

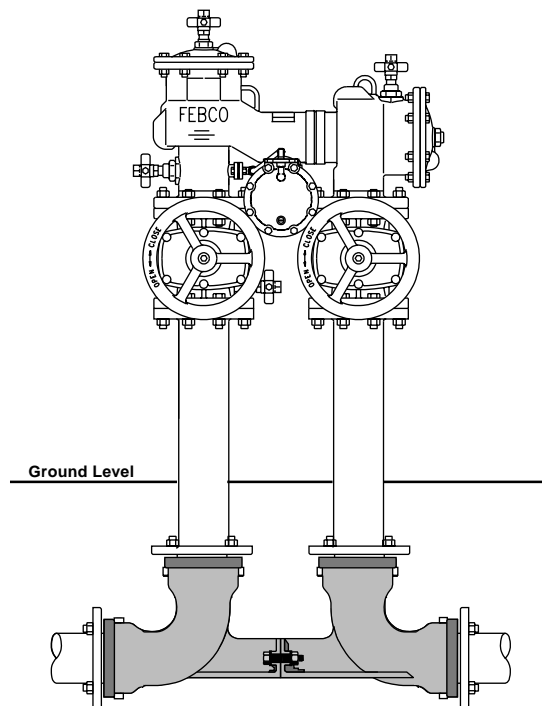

### Material Specifications

Part	Material
Body	Ductile iron A536 GR 65-45-12
Coating	Fusion epoxy coated internal and external AWWA C550
Bolts & Nuts	Stainless steel

\* Mechanical joint accessories and gaskets are not included (except for center joint).

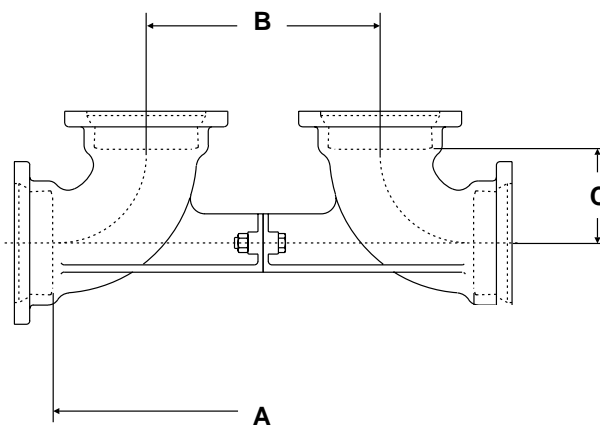

### Dimensions

Size: in (mm)	3"	4"	6"	8"	40" (1016.00)
A	21½" (546.10)	24" (609.60)	29" (736.60)	33½" (850.90)	40" (1016.00)
B	12½" (317.50)	14" (355.60)	16" (406.40)	18½" (469.90)	21" (533.40)
C	4½" (114.30)	5" (127.00)	6½" (165.10)	7½" (190.50)	9½" (241.30)
Weight: lbs (kg)	69 (31.30)	96 (43.54)	152 (68.94)	216 (97.97)	288 (130.63)

**Distributed by:**  
**Daniel L. Jerman Co.**  
 275 Railroad Place  
 Hackensack, NJ 07601

Phone 800.654.3733  
 Fax 201.487.3953  
 International Phone 201.487.7444

